

This document must be retained for future reference.

It is the responsibility of the person installing the electrical equipment to ensure that the installation meets the requirements of the IET wiring regulations and is therefore 'fit for purpose'. Factors such as correct selection of components, cable sizing, protective devices and Earth bonding are all critical and should be checked prior to full testing and power-up. Any other regulations applicable to the equipment being installed such as the Machinery Directive and current health and safety legislation must also be adhered to.

All connections (including factory made) must be checked for the correct tightness prior to commissioning of the electrical installation.  
All connections should also be inspected periodically to ensure correct tightness.

DO NOT USE POWER TOOLS ON THESE PRODUCTS



## LBFD160-2003P/PSN AC-23@400V(415V)

### Door Interlocked BS88 Switch Fuses

- IP65
- EN 60947-1 & 3 Compliant

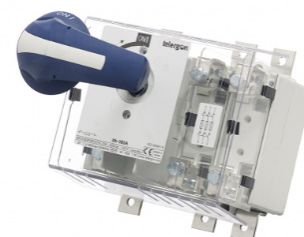

Data	Range	Units	LBFD1603P LBFD1603PSN	LBFD2003P LBFD2003PSN
BS88 Fuse size	-	-	A4	B1-B2
Rated thermal current I <sub>th</sub> at 40°C	Amps	A	160	200
Rated insulation voltage U <sub>i</sub>	Volts	V	800	800
Rated dielectric strength	Volts	kV	6	6
Rated impulse voltage U <sub>imp</sub>	Volts	kV	8	8
Rated operational current I <sub>e</sub> at 400V AC-22	Amps	A	160	200
Rated operational current I <sub>e</sub> at 400V AC-23	Amps	A	160	200
Rated operational power P <sub>e</sub> at 400V AC-23	Watts	kW	90	110
Rated breaking capacity	Amps	A	1280	1600
Rated making capacity	Amps	A	1600	2000
Rated short circuit making current (rms) with fuses fitted	Amps	kA	80	80
Rated short circuit withstand current (rms) with fuses fitted	Amps	kA	80	80
Minimum number of mechanical operations	-	Cycles	10,000	10,000
Minimum number of electrical operations @ 400V AC-23	-	Cycles	1,000	1,000
Terminal Capacity (rigid copper cable)	-	mm <sup>2</sup>	120	120
Lug bolt size	-	-	M8	M8
Maximum size of busbar connection	-	mm	5x25	5x25
Tightening torque	-	Nm	13	13

**LBFD160-2003P/PSN AC-23@400V(415V)**

## Door Interlocked BS88 Switch Fuses

## Enclosure Dimensions

Dimensions (mm)									
A		B		C	D	E	S	Ø	ØT
3P	4P	3P	4P						
200	239	82,5	121,5	168	192	3	115	8,5	M8

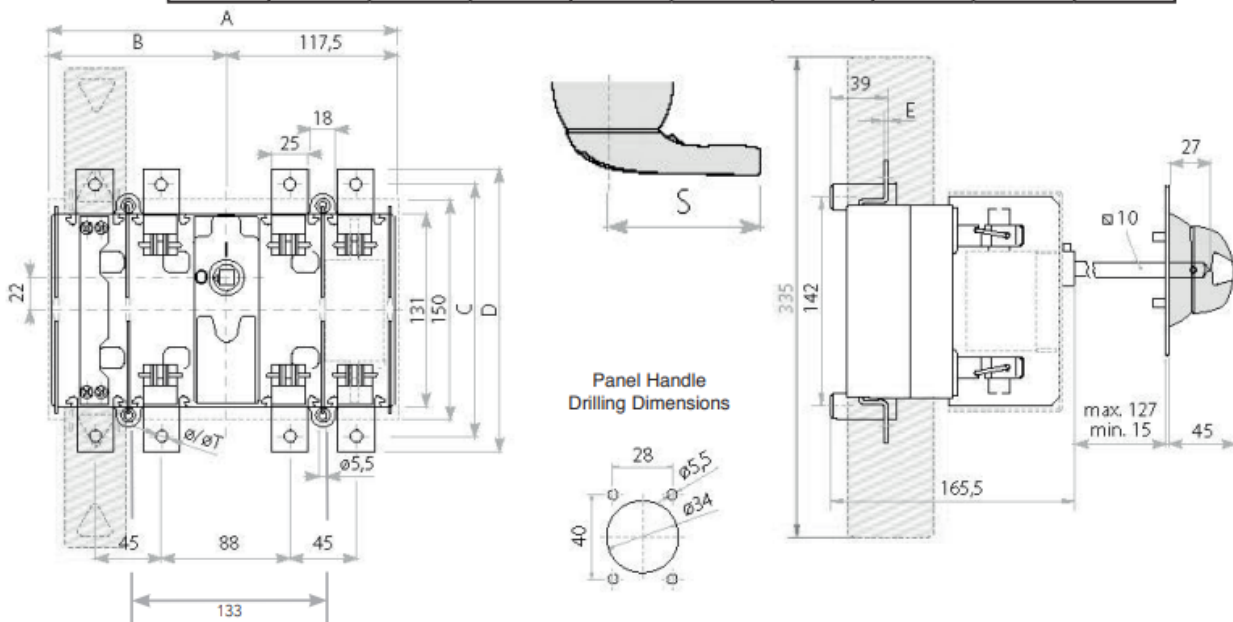

## Terminal Configuration

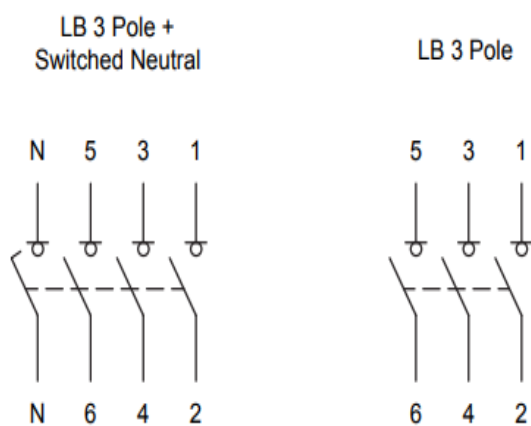

### Maximum BS88 Fuse Sizes

	A	B Ø	D	G	H	J
Fuses	Max	Max	Max	Nom	Nom	Min
A4	70	37	111	94	8,7	9,5
B1			138	111		11
B2						

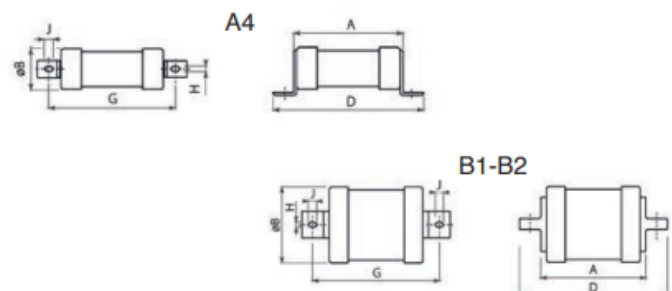

## LBFD160-2003P/PSN AC-23@400V(415V)

Door Interlocked BS88 Switch Fuses



### Handle Assembly:

1. Ensure that the handle is in the off position and locate the handle on to the door with the handle showing the off position at 9 o' clock
2. Tighten the four M5, flange nuts to 1.5Nm

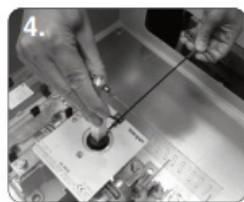

### Shaft Assembly:

3. Ensure that the switch is in the off position and fully insert the shaft into the switch with the cross pin in a horizontal position

4. Tighten the M5 shaft grub screw to 1.2Nm using a 2.5mm A/F allen key

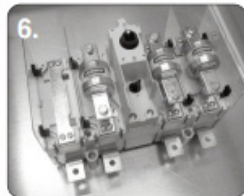
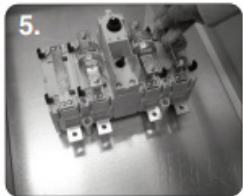

### Fuse Shroud Assembly: (SWITCH FUSE ONLY)

- 5/6. Install the four upright shrouds into the corresponding clips

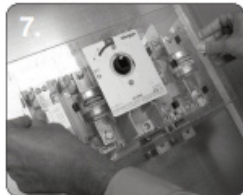

7. Install fuse shroud into the corresponding clips

## Padlock Operation

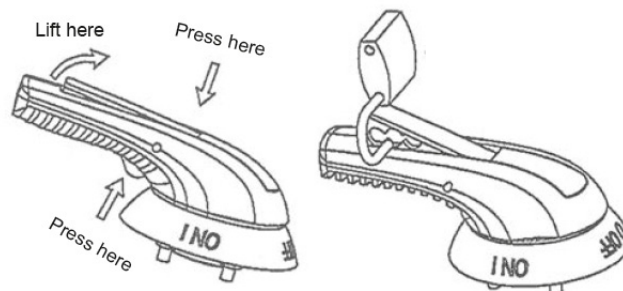

## Door Interlock Defeat

### Mechanism (For Authorised Personnel Only);

### WARNING! ACCESS TO LIVE PARTS

- Ensure that the door is closed and the handle is in the on position
- Locate the hole on the right side of the handle, then push and hold a small pin into the hole to activate the defeat mechanism
- The door can now be opened in the on position. Remove pin and close the door to reset the mechanism



## Handles, Shafts and Extended Shafts for Enclosed and Door Interlocked BS88 Switched Fuse

Product Prefix	Blue & White Handle	Red & Yellow Handle	Shaft Section (mm)	L (mm)	P (mm)	S (mm)	D (mm)
Standard Handle and Shafts							
LBF125/LBFD125	LBPHBW100	LBPHRY100	□7	250	165-282	94	45
LBF160/LBFD160	LBPHBW020	LBPHRY020	□10	227	180-292	115	
LBF200/LBFD200							
LBF315/LBFD315	LBPHBW040	LBPHRY040	□14	239	216-286	176	
LBF400/LBFD400							
LBF630/LBFD630	LBPHBW050	LBPHRY050		186	235-286		60
LBF800/LBFD800							
Extended Shafts							
Product Prefix	Extended Shaft Type 1	Shaft Section (mm)	L (mm)	P (mm)	Extended Shaft Type 2	L (mm)	P(mm)
LBFD125	LBES020	□7	387	165-419	Not Available		
LBFD160	LBES030	□10	375	180-440	LBES040	536	180-601
LBFD200							
LBFD315	LBES050	□14	345	216-392	LBES060	535	216-582
LBFD400				235-445			235-635
LBFD630							
LBFD800							

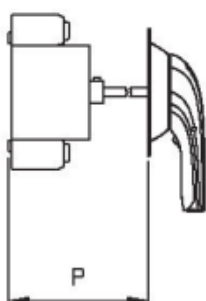

P=DISTANCE FROM  
THE BACK OF THE  
SWITCH TO THE INSIDE  
OF THE PANEL

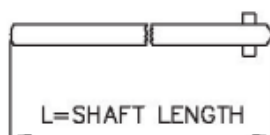

L=SHAFT LENGTH

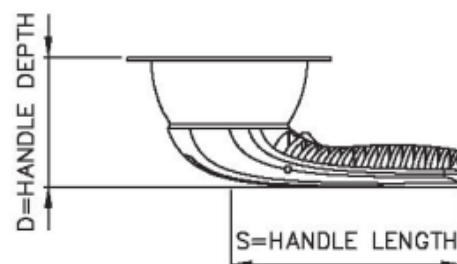

D=HANDLE DEPTH

S=HANDLE LENGTH