

This document must be retained for future reference.

It is the responsibility of the person installing the electrical equipment to ensure that the installation meets the requirements of the IET wiring regulations and is therefore 'fit for purpose'. Factors such as correct selection of components, cable sizing, protective devices and Earth bonding are all critical and should be checked prior to full testing and power-up. Any other regulations applicable to the equipment being installed such as the Machinery Directive and current health and safety legislation must also be adhered to.

All connections (including factory made) must be checked for the correct tightness prior to commissioning of the electrical installation.
All connections should also be inspected periodically to ensure correct tightness.

DO NOT USE POWER TOOLS ON THESE PRODUCTS



IP65 Epoxy Powder Coated Steel Pent Hood Enclosures

Dimensions

Part Number	A	B	C	D	E
STBPH504020	500	400	200	580	260
STBPH604020	600	400	200	680	260
STBPH604030	600	400	300	680	360
STBPH806030	800	600	300	880	360

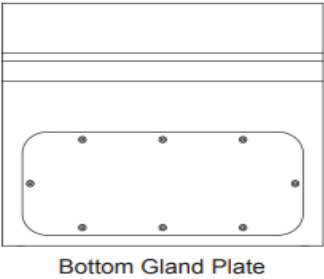
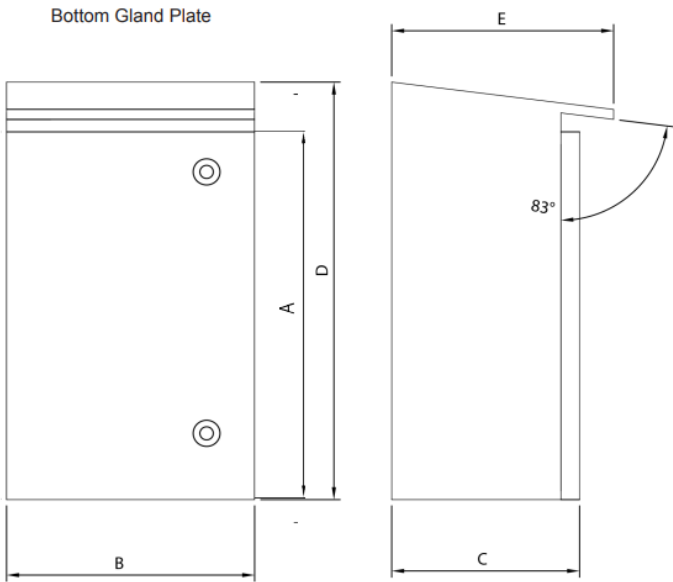

Please note:

The IP65 rated steel enclosures are protected against dust and low pressure jets of water from all directions – limited ingress is permitted as per EN60529. These enclosures are not suitable for floor mounting.

The powder coated finish will require regular maintenance especially when subjected to external environmental conditions. All surfaces that have been cut or drilled must be treated to prevent rust and all swarf and metal fillings must also be removed.

These enclosures are not recommended for harsh environments or areas containing chemicals such as chlorine or sodium and any other acidic compounds or salty coastal regions.