

This document must be retained for future reference.

It is the responsibility of the person installing the electrical equipment to ensure that the installation meets the requirements of the IET wiring regulations and is therefore 'fit for purpose'. Factors such as correct selection of components, cable sizing, protective devices and Earth bonding are all critical and should be checked prior to full testing and power-up. Any other regulations applicable to the equipment being installed such as the Machinery Directive and current health and safety legislation must also be adhered to.

All connections (including factory made) must be checked for the correct tightness prior to commissioning of the electrical installation.
All connections should also be inspected periodically to ensure correct tightness.

DO NOT USE POWER TOOLS ON THESE PRODUCTS



IP67 Inspection Windows IW4M|IW6M|IW8M|IW12M

The polycarbonate weatherproof inspection window offers IP67 protection when fitted correctly. (IEC 60529 / EN 60309). Available in 4, 6, 8, or 12 module options the inspection window is a quick easy way to upgrade a wide variety of enclosures. Supplied complete with fixing bracket and din rail to take standard modular components such as MCBs, fuse holders and time clocks.

IW4M (4 Module)

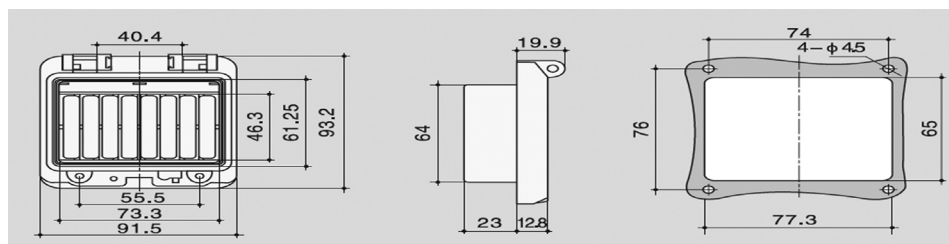

All supplied complete with fixing bracket and din rail

IW6M (6 Module)

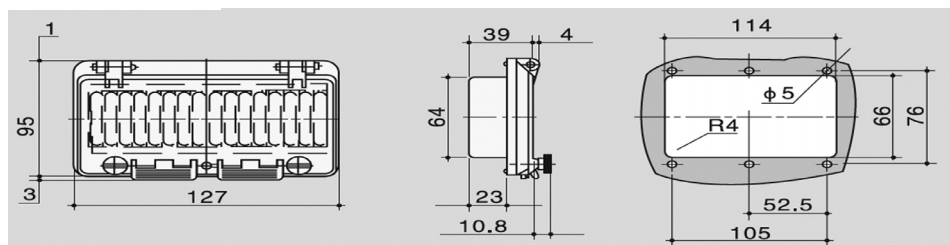

IW8M (8 Module)

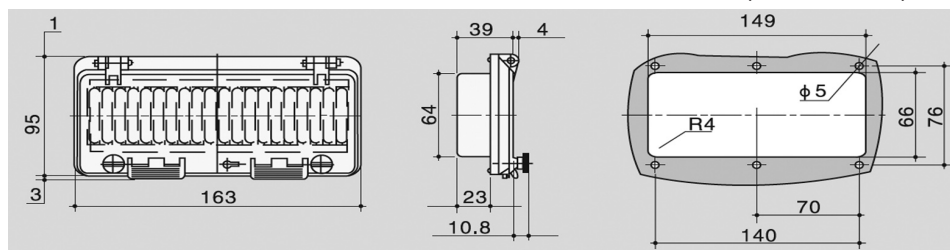

Overall depth on all units (inc. fixings) 75mm

IW12M (12 Module)

