

This document must be retained for future reference.

It is the responsibility of the person installing the electrical equipment to ensure that the installation meets the requirements of the IET wiring regulations and is therefore 'fit for purpose'. Factors such as correct selection of components, cable sizing, protective devices and Earth bonding are all critical and should be checked prior to full testing and power-up. Any other regulations applicable to the equipment being installed such as the Machinery Directive and current health and safety legislation must also be adhered to.

All connections (including factory made) must be checked for the correct tightness prior to commissioning of the electrical installation.
All connections should also be inspected periodically to ensure correct tightness.

DO NOT USE POWER TOOLS ON THESE PRODUCTS



Manual Motor Starters
MMS-XXSX

Features & Benefits

- Thermal and short circuit protection of AC electric motors with power up to 15kW (380 / 440V) 32A; can also be used as a main switch
- Simple snap fitting on 35mm mounting rail

Terminal Capacity (max. 2 cables per terminal)

Minimum Cross Section	0.5mm²
Maximum Cross Section	6mm²

Tightening Torque: 2Nm

Wire Strip Length: 10mm



Type	Setting Range (A)	Magnetic Release Current (A)	50/60Hz, AC-3 3-Phase Motor Related Power				Rated Service Short-Circuit Breaking Capacity Ics (kA)	Rated Ultimate Short-Circuit Breaking Capacity Icu (kA)	Pole Impedance (Ω)
			230V (kW)	400V (kW)	415V (kW)	440V (kW)			
MMS-016S	0.1-0.16	1.5	-	-	-	-	100	100	70Ω
MMS-025S	0.16-0.25	2.4	-	-	-	-			29Ω
MMS-04S	0.25-0.4	5	-	-	-	-			10Ω
MMS-063S	0.4-0.63	8	-	-	-	-			3.8Ω
MMS-1S	0.63-1	13	-	-	-	0.37			1.6Ω
MMS-1.6S	1-1.6	22.5	-	0.37	-	0.55			730mΩ
MMS-2.5S	1.6-2.5	33.5	0.37	0.75	0.75	1.1			280mΩ
MMS-4S	2.5-4	51	0.75	1.5	1.5	1.5			120mΩ
MMS-6.3S	4-6.3	78	1.1	2.2	2.2	3			50mΩ
MMS-10S	6-10	138	2.2	4	4	4			24mΩ
MMS-14S	9-14	170	3	5.5	5.5	7.5	7.5	15	15mΩ
MMS-18S	13-18	223	4	7.5	9	9			9mΩ
MMS-23S	17-23	327	5.5	11	11	11	6		6mΩ
MMS-25S	20-25	327	5.5	11	11	11			5mΩ
MMS-32S	24-32	416	7.5	15	15	15	5	10	3.5mΩ

MMS Dimensions

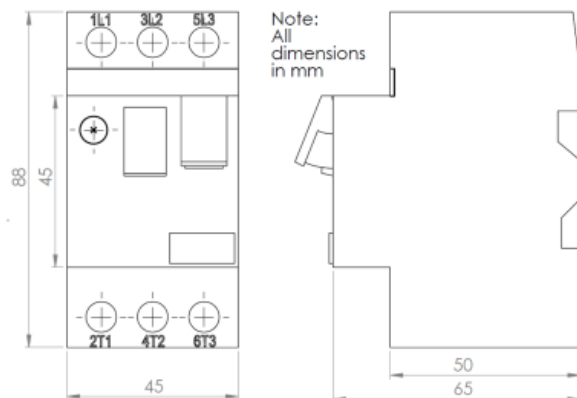

Single-Phase Wiring

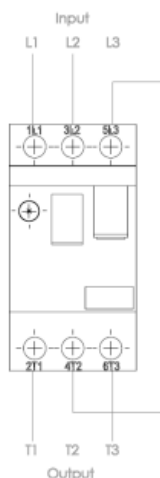

Three-Phase Wiring



MMS Range Accessories

Fitting instructions available at www.europacomponents.com

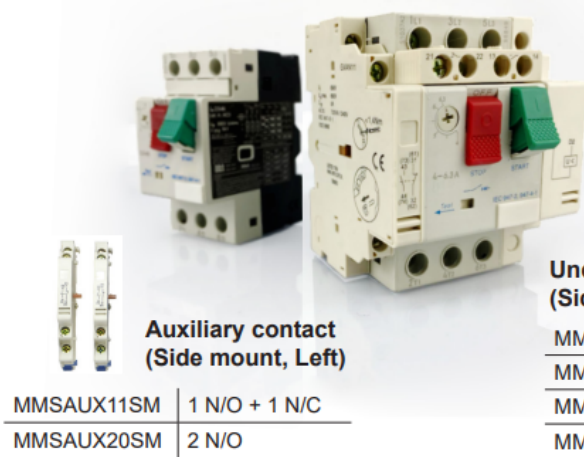

Auxiliary contact (Top mount)

MMSAUXAE11	1 N/O + 1 N/C
MMSAUXAE20	2 N/O

Under voltage trip (Side mount, Right)

MMSU24	24V
MMSU110	110V
MMSU240	220-240V
MMSU415	380-415V

Auxiliary contact (Side mount, Left)

MMSAUX11SM	1 N/O + 1 N/C
MMSAUX20SM	2 N/O

MMSENC

IP55 Enclosure for MMS 0.1-32A

