

This document must be retained for future reference.

It is the responsibility of the person installing the electrical equipment to ensure that the installation meets the requirements of the IET wiring regulations and is therefore 'fit for purpose'. Factors such as correct selection of components, cable sizing, protective devices and Earth bonding are all critical and should be checked prior to full testing and power-up. Any other regulations applicable to the equipment being installed such as the Machinery Directive and current health and safety legislation must also be adhered to.

All connections (including factory made) must be checked for the correct tightness prior to commissioning of the electrical installation.
All connections should also be inspected periodically to ensure correct tightness.

DO NOT USE POWER TOOLS ON THESE PRODUCTS



LBC315-4003PSNGP AC-22 @400V (415V) Enclosed Door Interlocked Changeover Switches

- EN 60947-1 & 3 Compliant
- IP66



Data	Range	Units	LBC3153PSNGP	LBC4003PSNGP
Rated thermal current I _{th} at 40°C	Amps	A	315	400
Rated insulation voltage U _i	Volts	V	1000	1000
Rated dielectric strength	Volts	kV	6	6
Rated impulse voltage U _{imp}	Volts	kV	8	8
Rated operational current I _e at 400V AC-22	Amps	A	315	400
Rated operational current I _e at 400V AC-23	Amps	A	200	250
Rated operational power P _e at 400V AC-23	Watts	kW	100	125
Rated breaking capacity	Amps	A	1600	2000
Rated making capacity	Amps	A	2000	2500
Rated short circuit making capacity (peak value) I _{cm}	Amps	kA	12	12
Rated short-time withstand current (1 sec) rms I _{cw}	Amps	kA	8	8
Minimum number of mechanical operations	-	Cycles	10,000	10,000
Minimum number of electrical operations @ 400V AC-22	-	Cycles	1,000	200
Terminal Capacity (rigid copper cable)	-	mm ²	240	240
Lug bolt size	-	-	M10	M10
Maximum size of busbar connection	-	mm	2x5x30	2x5x30
Tightening torque	-	Nm	24	24

LBC315-4003PSNGP AC-22 @400V (415V)

Enclosed Door Interlocked Changeover Switches

Enclosure Dimensions

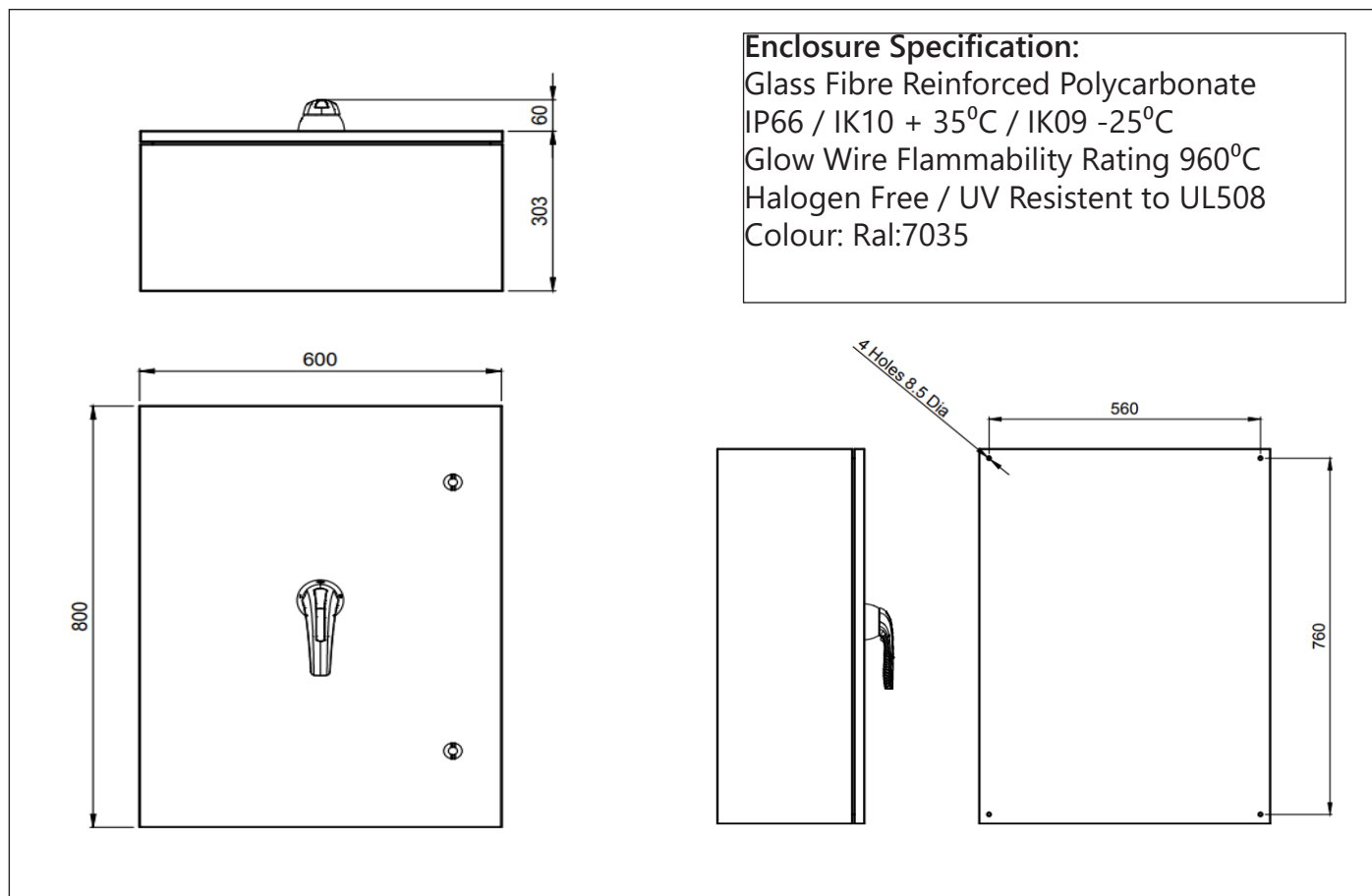

Terminal Configuration

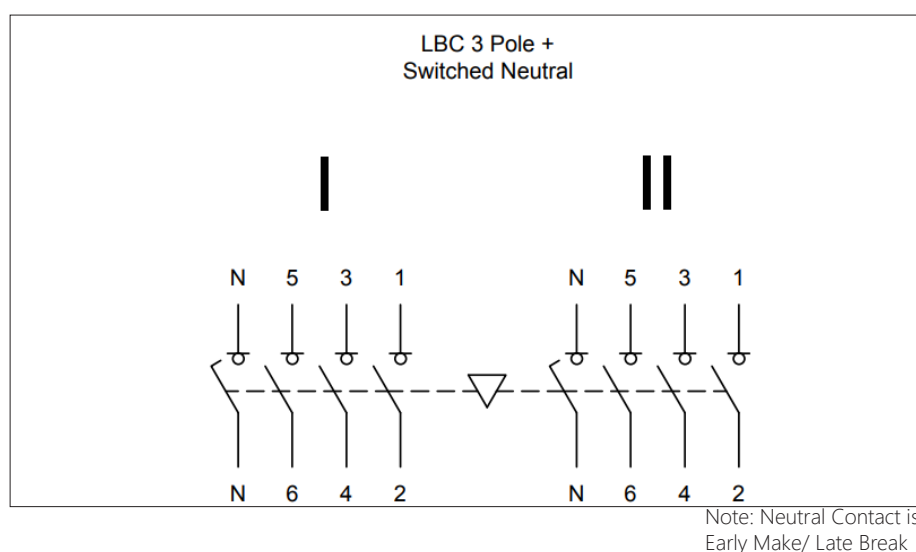

LBC315-4003PSNGP AC-22 @400V (415V)

Enclosed Door Interlocked Changeover Switches



Handle Assembly:

1. Ensure that the handle is in the off position and locate the handle on to the door with the handle showing the off position at 9 o' clock
2. Tighten the four M5, flange nuts to 1.5Nm

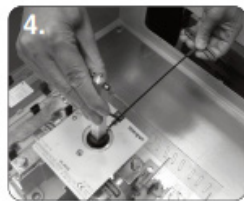
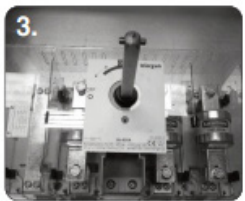

Shaft Assembly:

3. Ensure that the switch is in the off position and fully insert the shaft into the switch with the cross pin in a horizontal position
4. Tighten the M5 shaft grub screw to 1.2Nm using a 2.5mm A/F allen key

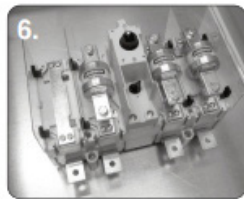
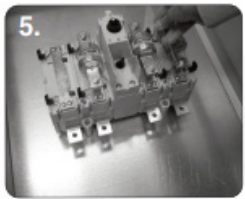

Fuse Shroud Assembly:

(160-800A SWITCH FUSE ONLY)

- 5/6. Install the four upright shrouds into the corresponding clips
7. Install fuse shroud into the corresponding clips

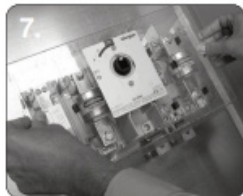

Padlock Operation

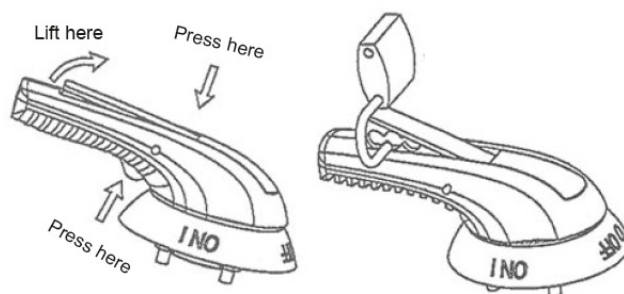

Door Interlock Defeat

Mechanism (For Authorised Personnel Only);

WARNING! ACCESS TO LIVE PARTS

- Ensure that the door is closed and the handle is in the on position
- Locate the hole on the right side of the handle, then push and hold a small pin into the hole to activate the defeat mechanism
- The door can now be opened in the on position. Remove pin and close the door to reset the mechanism

