

This document must be retained for future reference.

It is the responsibility of the person installing the electrical equipment to ensure that the installation meets the requirements of the IET wiring regulations and is therefore 'fit for purpose'. Factors such as correct selection of components, cable sizing, protective devices and Earth bonding are all critical and should be checked prior to full testing and power-up. Any other regulations applicable to the equipment being installed such as the Machinery Directive and current health and safety legislation must also be adhered to.

All connections (including factory made) must be checked for the correct tightness prior to commissioning of the electrical installation. All connections should also be inspected periodically to ensure correct tightness.

DO NOT USE POWER TOOLS ON THESE PRODUCTS



Plastic and Metal Emergency Stop Stations

Plastic: RCAS-ESB141NC, RCAS-ESB541NC, RCASESBC41NC, RCAS-ESBT42NC, RCAS-ESB5641NC

Metal: RM1BS142, RM1BS542, RM1BS5642

- EN 60947 Compliant
- Operating Temperature -25°C to +70°C
- IP65 rated enclosure
- Base mounted contact block for easy
- With N/C Contact rated 10A at 240V
- Provision for additional contact block
- PG13.5 / M20 Knock-outs top & bottom (Plastic)
- M20 Threaded entries top & bottom (Metal)

Plastic Emergency Stop Station



- RCAS-ESB141NC - Key Release + 1N/C
- RCAS-ESB541NC - Twist Release + 1N/C
- RCAS-ESBC41NC - Spring Release + 1N/C
- RCAS-ESBT42NC - Pull Release + 2N/C
- RCAS-ESB5641NC - 60mm Twist + 1N/C

Metal Emergency Stop Station



- RM1BS142 - Key Release + 1N/C
- RM1BS542 - Twist Release + 1N/C
- RM1BS5642 - 60mm Twist + 1N/C

Dimensions

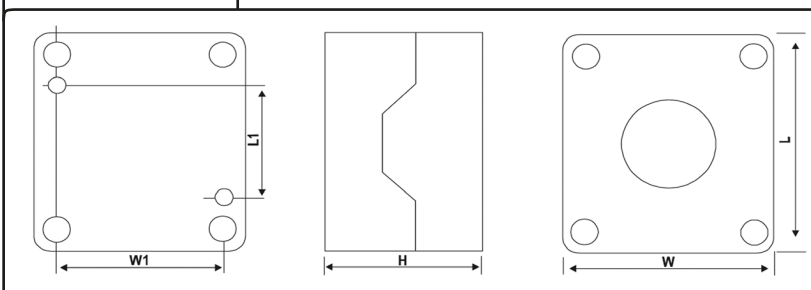

Plastic and Metal

Measurement	1 Hole
H	51mm
W	68mm
L	74mm
W1	54mm
L1	38mm(P) / 46mm(M)

